

Parts List

FMC Deluxe Adapter Kit (P/N 380-80009-00)

| FMC Part No. | RTI Part No. | Description | Qty |
|--------------|--------------|-----------------------------------|-----|
| 91165 | 080-80000-60 | Threaded Adapter 08 (M12 x 1.25) | 2 |
| 91176 | 080-80000-95 | Threaded Adapter 62 (7/16 x 14NC) | 2 |
| 90785 | 080-80000-70 | Ford F150 Adapter | 1 |
| 90837 | 080-80000-82 | GM W-Body Adapter | 1 |
| 90817 | 080-80000-68 | Cutting Tips (10 per Box) | 1 |
| 90786 | 080-80000-11 | 100mm Twin Cylinder Clamp | 2 |
| 90838 | 080-80000-81 | Extended Wheel Drive Bracket | 2 |
| | 080-80000-98 | Hollow Adapter (28mm lg.) | 1 |
| | 080-80000-97 | Hollow Adapter (38mm lg.) | 1 |
| | 080-80001-22 | Bolt 10mm x 1.50 x 90mm lg. | 2 |

Parts List

FMC Model 505 (Japan) - Lathe Head (480-80015-01)

| FMC Part No. | RTI Part No. | Description | Qty |
|--------------|----------------|----------------------------------|-----|
| 90819 | 080-80000-03 | Bracket Twin Cylinder (70mm) | 2 |
| 90786 | 080-80000-11 | Bracket Twin Cylinder (100mm) | 2 |
| 90820 | 080-80000-04 | Band Silencer | 1 |
| 90821 | 080-80000-05 | Wrench Hex Key (6mm) | 1 |
| 90822 | 080-80000-06 | Wrench Hex Key (8mm) | 1 |
| 90831 | 080-80000-07 | Spacer Mounting | 6 |
| 90824 | 080-80000-08 | Bar Threaded | 2 |
| 90823 | 080-80000-09 | Hook "S" Shaped | 2 |
| 90826 | 080-80000-45 | Threaded Adapter 03 (M10 x 1.25) | 2 |
| 90827 | 080-80000-46 | Threaded Adapter 05 (M10 x 1.50) | 2 |
| 91165 | 080-80000-80 | Threaded Adapter 08 (M12 x 1.25) | 2 |
| 90828 | 080-80000-47 | Threaded Adapter 09 (M12 x 1.50) | 2 |
| 90829 | 080-80000-48 | Threaded Adapter 44 (M11 x 1.50) | 2 |
| 90825 | * 080-80000-10 | Hollow Adapter (48 mm lg.) | 2 |
| | | Bolt 8mm x 1.25 x 70mm lg. | 2 |
| | | Bolt 10mm x 1.50 x 70mm lg. | 2 |
| 91200 | 080-80001-21 | Bolt 8mm x 1.25 x 90mm lg. | 2 |
| 91178 | 080-80001-22 | Bolt 10mm x 1.50 x 90mm lg. | 2 |
| 91177 | 080-80000-97 | Hollow Adapter (38mm lg.) | 2 |
| 90833 | 080-80000-14 | Cord 12 Volt Coiled | 1 |
| 90818 | 080-80000-02 | Handle Lathe Carrying | 1 |

* Earlier lathes had Hollow Adapters 38mm lg. and Bolts 60mm lg.

Complete Unit (480-80015-00) Includes: Lathe Head (480-80015-01)
Drive Stand & Motor (480-80015-02)

Parts List

FMC Model 505 - Lathe Head (480-80004-01)

| FMC Part No. | RTI Part No. | Description | Qty |
|--------------|----------------|----------------------------------|-----|
| 90819 | 080-80000-03 | Bracket Twin Cylinder (70mm) | 2 |
| 90820 | 080-80000-04 | Band Silencer | 1 |
| 90821 | 080-80000-05 | Wrench Hex Key (6mm) | 1 |
| 90822 | 080-80000-06 | Wrench Hex Key (8mm) | 1 |
| 90831 | 080-80000-07 | Spacer Mounting | 6 |
| 90824 | 080-80000-08 | Bar Threaded | 2 |
| 90823 | 080-80000-09 | Hook "S" Shaped | 2 |
| 90825 | * 080-80000-10 | Adapter Hollow (48mm lg.) | 2 |
| | | Bolt 8mm (70mm lg.) | 2 |
| | | Bolt 10mm (70mm lg.) | 2 |
| 90826 | 080-80000-45 | Threaded Adapter 03 (M10 x 1.25) | 2 |
| 90827 | 080-80000-46 | Threaded Adapter 05 (M10 x 1.50) | 2 |
| 90828 | 080-80000-47 | Threaded Adapter 09 (M12 x 1.50) | 2 |
| 90829 | 080-80000-48 | Threaded Adapter 44 (M11 x 1.50) | 2 |
| 90830 | 080-80000-49 | Threaded Adapter 48 (M9 x 1.25) | 2 |
| 91126 | 080-80000-79 | Threaded Adapter 60 (M14 x 2.00) | 2 |
| 90833 | 080-80000-14 | Cord 12 Volt Coiled | 1 |
| 90818 | 080-80000-02 | Handle Lathe Carrying | 1 |

* Earlier lathes had Hollow Adapters 38mm lg. and Bolts 60mm lg.

Complete Unit (480-80004-00) Includes: Lathe Head (480-80004-01)
Drive Stand & Motor (480-80004-02)

Parts List

Toyota Adapter Kit (P/N 380-80017-00)

| FMC Part No. | RTI Part No. | Description | Qty |
|--------------|--------------|------------------------------|-----|
| 91165 | 080-80000-80 | Threaded Adapter 08 | 2 |
| 90786 | 080-80000-11 | 100mm Twin Cylinder Clamp | 2 |
| 91177 | 080-80000-97 | 38mm lg. Hollow Adapter | 1 |
| | 080-80000-98 | 28mm lg. Hollow Adapter | 1 |
| 91178 | 080-80001-22 | 10mm x 1.50 x 90mm lg. Bolt | 2 |
| 90838 | 080-80000-81 | Extended Wheel Drive Barcket | 2 |

Parts List

FMC Model 505 - Lathe Head (P/N 480-80034-00) Includes Fixed Speed Cable Set

| FMC Part No. | RTI Part No. | Description | Qty |
|--------------|----------------|----------------------------------|-----|
| 90819 | 080-80000-03 | Bracket Twin Cylinder (70mm) | 2 |
| 90820 | 080-80000-04 | Band Silencer | 1 |
| 90821 | 080-80000-05 | Wrench Hex Key (6mm) | 1 |
| 90822 | 080-80000-06 | Wrench Hex Key (8mm) | 1 |
| 90831 | 080-80000-07 | Spacer Mounting | 6 |
| 90824 | 080-80000-08 | Bar Threaded | 2 |
| 90823 | 080-80000-09 | Hook "S" Shaped | 2 |
| 90825 | * 080-80000-10 | Adapter Hollow (48mm lg.) | 2 |
| | | Bolt 8mm (70mm lg.) | 2 |
| | | Bolt 10mm (70mm lg.) | 2 |
| 90826 | 080-80000-45 | Threaded Adapter 03 (M10 x 1.25) | 2 |
| 90827 | 080-80000-46 | Threaded Adapter 05 (M10 x 1.50) | 2 |
| 90828 | 080-80000-47 | Threaded Adapter 09 (M12 x 1.50) | 2 |
| 90829 | 080-80000-48 | Threaded Adapter 44 (M11 x 1.50) | 2 |
| 90830 | 080-80000-49 | Threaded Adapter 48 (M9 x 1.25) | 2 |
| 91126 | 080-80000-79 | Threaded Adapter 60 (M14 x 2.00) | 2 |
| 90833 | 080-80000-14 | Cord 12 Volt Coiled | 1 |
| 90818 | 080-80000-02 | Handle Lathe Carrying | 1 |
| | 380-80010-00 | Cable Battery | 1 |
| | 380-80012-00 | Cable fixed Voltage | 1 |

* Earlier lathes had Hollow Adapters 38mm lg. and Bolts 60mm lg.

Parts List

FMC Model 505 - Lathe Head (P/N 480-80034-01) Includes Variable Speed Cable Set

| FMC Part No. | RTI Part No. | Description | Qty |
|--------------|----------------|----------------------------------|-----|
| 90819 | 080-80000-03 | Bracket Twin Cylinder (70mm) | 2 |
| 90820 | 080-80000-04 | Band Silencer | 1 |
| 90821 | 080-80000-05 | Wrench Hex Key (6mm) | 1 |
| 90822 | 080-80000-06 | Wrench Hex Key (8mm) | 1 |
| 90831 | 080-80000-07 | Spacer Mounting | 6 |
| 90824 | 080-80000-08 | Bar Threaded | 2 |
| 90823 | 080-80000-09 | Hook "S" Shaped | 2 |
| 90825 | * 080-80000-10 | Adapter Hollow (48mm lg.) | 2 |
| | | Bolt 8mm (70mm lg.) | 2 |
| | | Bolt 10mm (70mm lg.) | 2 |
| 90826 | 080-80000-45 | Threaded Adapter 03 (M10 x 1.25) | 2 |
| 90827 | 080-80000-46 | Threaded Adapter 05 (M10 x 1.50) | 2 |
| 90828 | 080-80000-47 | Threaded Adapter 09 (M12 x 1.50) | 2 |
| 90829 | 080-80000-48 | Threaded Adapter 44 (M11 x 1.50) | 2 |
| 90830 | 080-80000-49 | Threaded Adapter 48 (M9 x 1.25) | 2 |
| 91126 | 080-80000-79 | Threaded Adapter 60 (M14 x 2.00) | 2 |
| 90833 | 080-80000-14 | Cord 12 Volt Coiled | 1 |
| 90818 | 080-80000-02 | Handle Lathe Carrying | 1 |
| | 380-80010-00 | Cable Battery | 1 |
| | 380-80013-00 | Cable Variable Voltage | 1 |
| | 380-80011-00 | Cable Cigar Lighter | 1 |

* Earlier lathes had Hollow Adapters 38mm lg. and Bolts 60mm lg.

Parts List

FMC Model 505 - Drive Stand & Motor (P/N 480-80004-02)

| FMC Part No. | RTI Part No. | Description | Qty |
|--------------|--------------|--------------------------------------|-----|
| | 080-80000-83 | Motor Gear Drive (Complete Assembly) | 1 |
| | 080-80000-15 | Motor Mount | 1 |
| | 080-80000-16 | Inner Column | 1 |
| | 080-80000-17 | Outer Column | 1 |
| | 080-80000-18 | Base | 1 |
| | 080-80000-19 | Short Leg | 2 |
| | 080-80000-20 | Long Leg | 1 |
| 91143 | 080-80000-21 | Swivel Caster | 3 |
| 91144 | 080-80000-22 | Locking Handle | 1 |
| | 080-80000-23 | Accessory Box Support | 1 |
| | 080-80000-24 | Bolt M6 x 1mm x 35mm Lg. | 4 |
| | 080-80000-25 | Bolt M8 x 1.25mm x 60mm Lg. | 3 |
| | 080-80000-26 | Bolt M8 x 1.25mm x 50mm Lg. | 2 |
| | 080-80000-27 | Bolt M10 x 1.50mm x 25mm Lg. | 2 |
| | 080-80000-28 | Bolt M10 x 1.50mm x 35mm Lg. | 1 |
| | 080-80000-29 | Washer M6 | 8 |
| | 080-80000-30 | Washer M8 | 8 |
| | 080-80000-31 | Washer M10 | 6 |
| | 080-80000-32 | Nut M6 x 1.00mm | 4 |
| | 080-80000-33 | Nut M8 x 1.25mm | 3 |
| | 080-80000-34 | Nut M10 x 1.50mm | 3 |

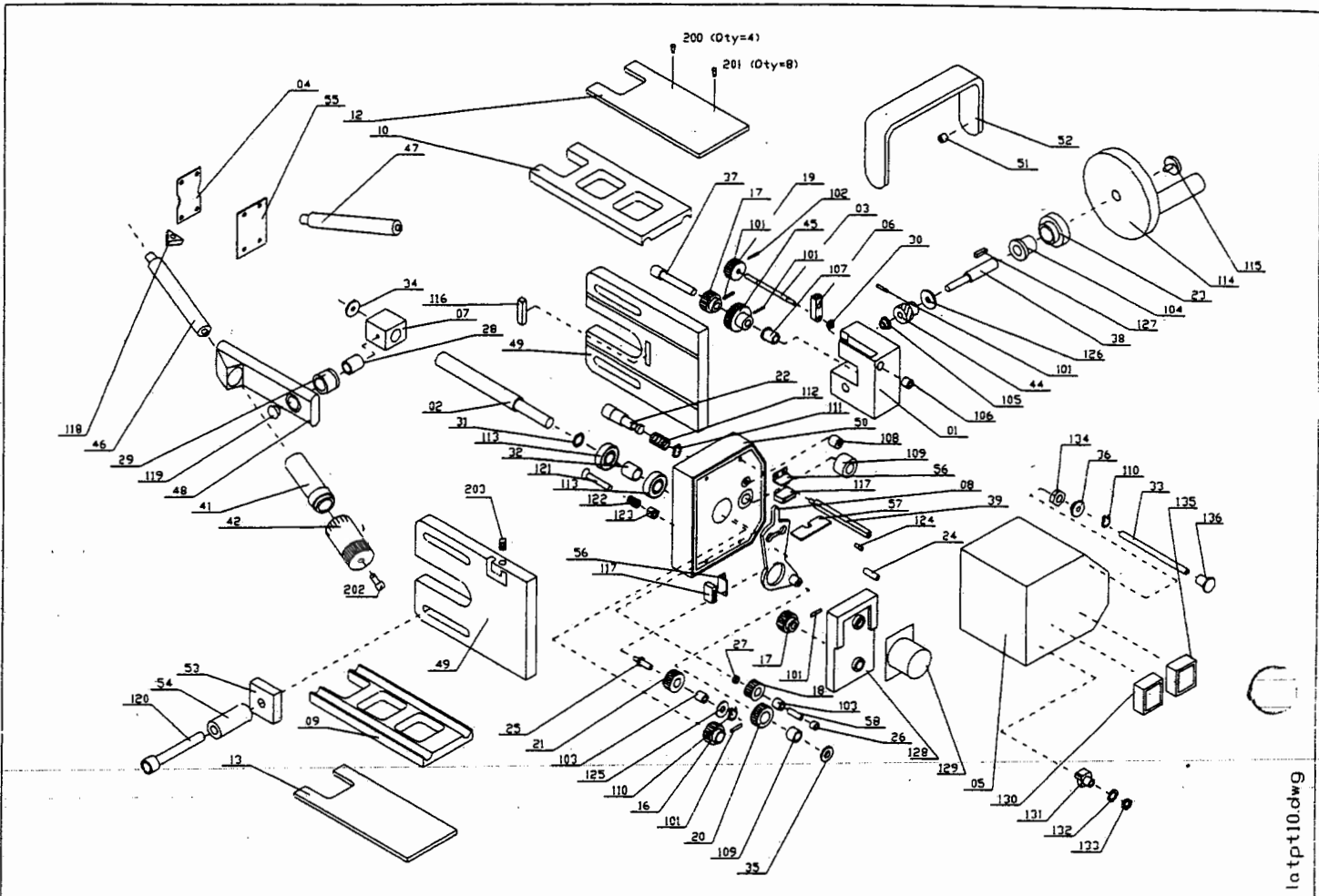

latpt10.dwg

| | | | | | | | |
|-----|--------------------------------|--------------|-------|---------------|------------------------------|--------------|-------|
| 04 | PLATE DRIVE BEARING COVER | 080-80001-63 | 91196 | 128 & 129 | MOTOR FEED DRIVE | 080-80000-57 | 91155 |
| 05 | ENCLOSURE LATHE CONTROL | 080-80000-50 | 91142 | | | | |
| 08 | LEVER AUTO/MANUAL SHIFT | 080-80000-51 | 91163 | 130 | LIGHT POWER INDICATOR | 080-80000-58 | 91133 |
| 22 | LEVER SHIFT LOCK | 080-80001-53 | 91158 | 131 | SOCKET 12V CORD | 080-80000-59 | 91156 |
| 33 | SHAFT AUTO FEED STOP | 080-80000-60 | 91138 | 135 | SWITCH IN/OUT FEED SELECTOR | 080-80000-61 | 91134 |
| 41 | SCALE MICROMETER | 080-80000-63 | 91159 | 136 | KNOB AUTO FEED STOP | 080-80000-62 | 91135 |
| 42 | KNOB MICROMETER | 080-80000-64 | 91139 | 200 | SCREW ADJUSTING ID#1 | 080-80001-59 | 91136 |
| 44 | GEAR | 080-80001-55 | 91160 | 201 | SCREW ADJUSTING ID#2 | 080-80001-60 | 91137 |
| 45 | GEAR | 080-80001-54 | 91161 | 202 | BOLT W/WASHER MICROMETER MTG | 080-80001-58 | 91157 |
| 46 | SHAFT KEYED MICROMETER (LEFT) | 080-80000-65 | 91140 | 203 | SCREW HANDLE RESTRAINT | 080-80001-64 | 91199 |
| 47 | SHAFT KEYED MICROMETER (RIGHT) | 080-80000-66 | 91141 | 53 & 54 & 120 | KIT THD BLOCK/SPACER/BOLT | 080-80000-55 | 91162 |
| 51 | STUD HANDLE MOUNTING | 080-80000-67 | 91197 | | | | |
| 52 | HANDLE LATHE CARRYING NO STUDS | 080-80001-02 | 91198 | | | | |
| 111 | RING SNAP | 080-80001-52 | 91131 | | | | |
| 114 | HANDWHEEL MANUAL FEED | 080-80000-52 | 91152 | | | | |
| 115 | SCREW HANDWHEEL MOUNTING | 080-80000-53 | 91153 | | | | |
| 117 | SWITCH LIMIT 5A SPDT | 080-80000-54 | 91132 | | | | |
| 127 | KEY HANDWHEEL | 080-80000-56 | 91154 | | | | |

"FOR REFERENCE ONLY"

FMC & RTI Parts List - Lathe Head

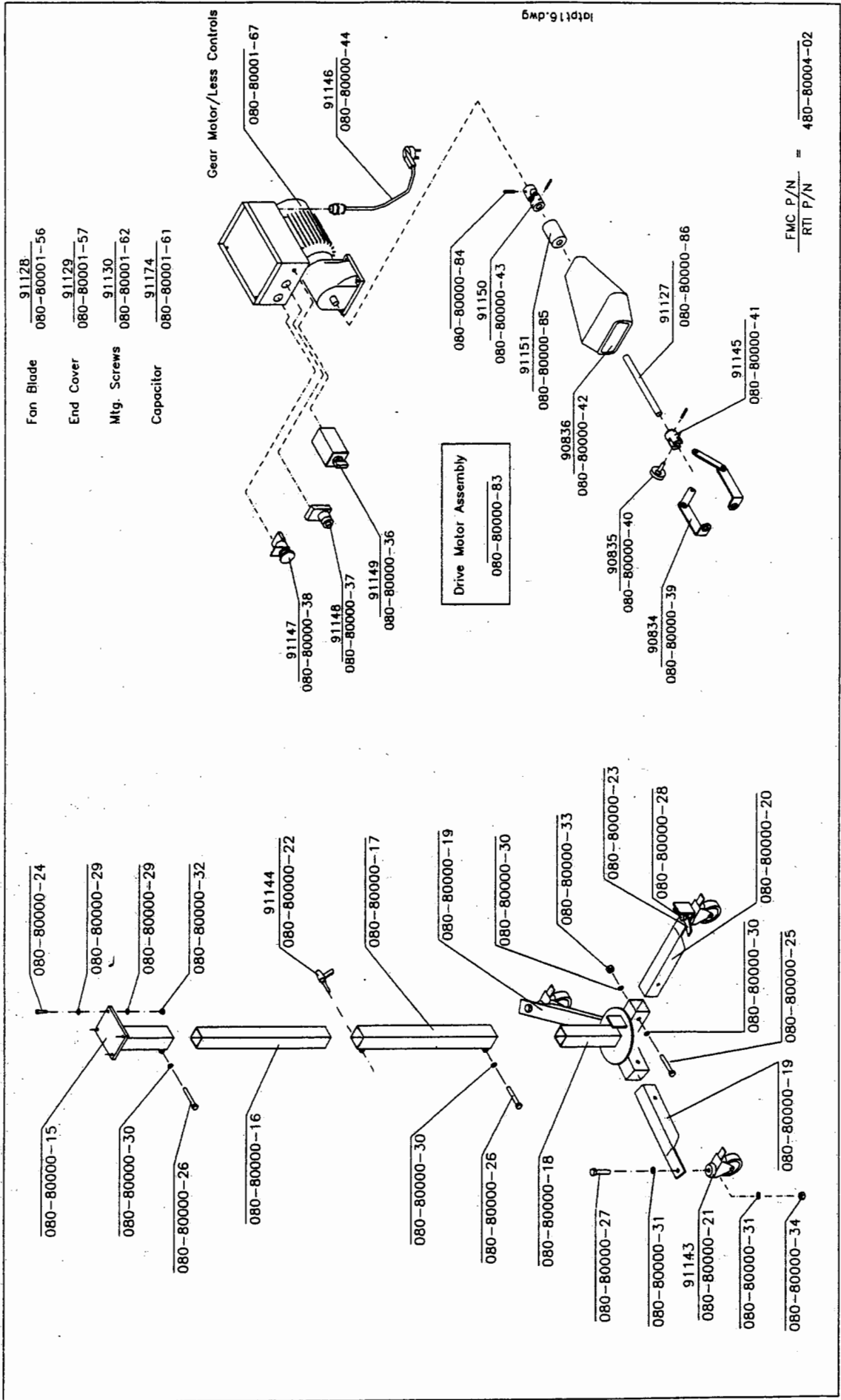

FMC P/N = 480-80004-02
RTI P/N =

FMC & RTI Parts List - Drive Stand & Motor Assembly
(All Parts Priced & Sold Individually)

91212 pos. rake tips box of 10

latpt11.dwg

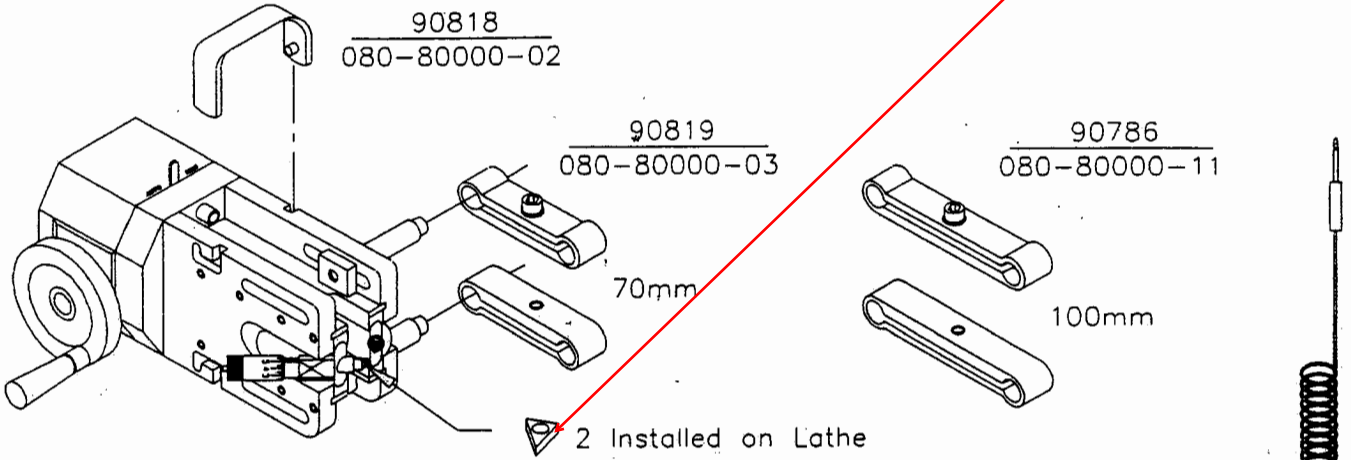

Re-order Cutting Tips (10 per Box)
 90817
 080-80000-68

03 90826
 080-80000-45

05 90827
 080-80000-46

08 91165
 080-80000-80

09 90828
 080-80000-47

44 90829
 080-80000-48

91200
 080-80001-21

91178
 080-80001-22

91177
 080-80000-97

90820
 080-80000-04

90821
 080-80000-05

90822
 080-80000-06

90831
 080-80000-07

90823
 080-80000-09

90833
 080-80000-14

90824
 080-80000-08

90825
 080-80000-10
 (Sold as a Set)

FMC P/N = 480-80015-01
 RTI P/N

FMC (Japan) & RTI Parts List - Lathe Head Components

(All Parts Priced & Sold Individually)

91212 pos rake kit. box of

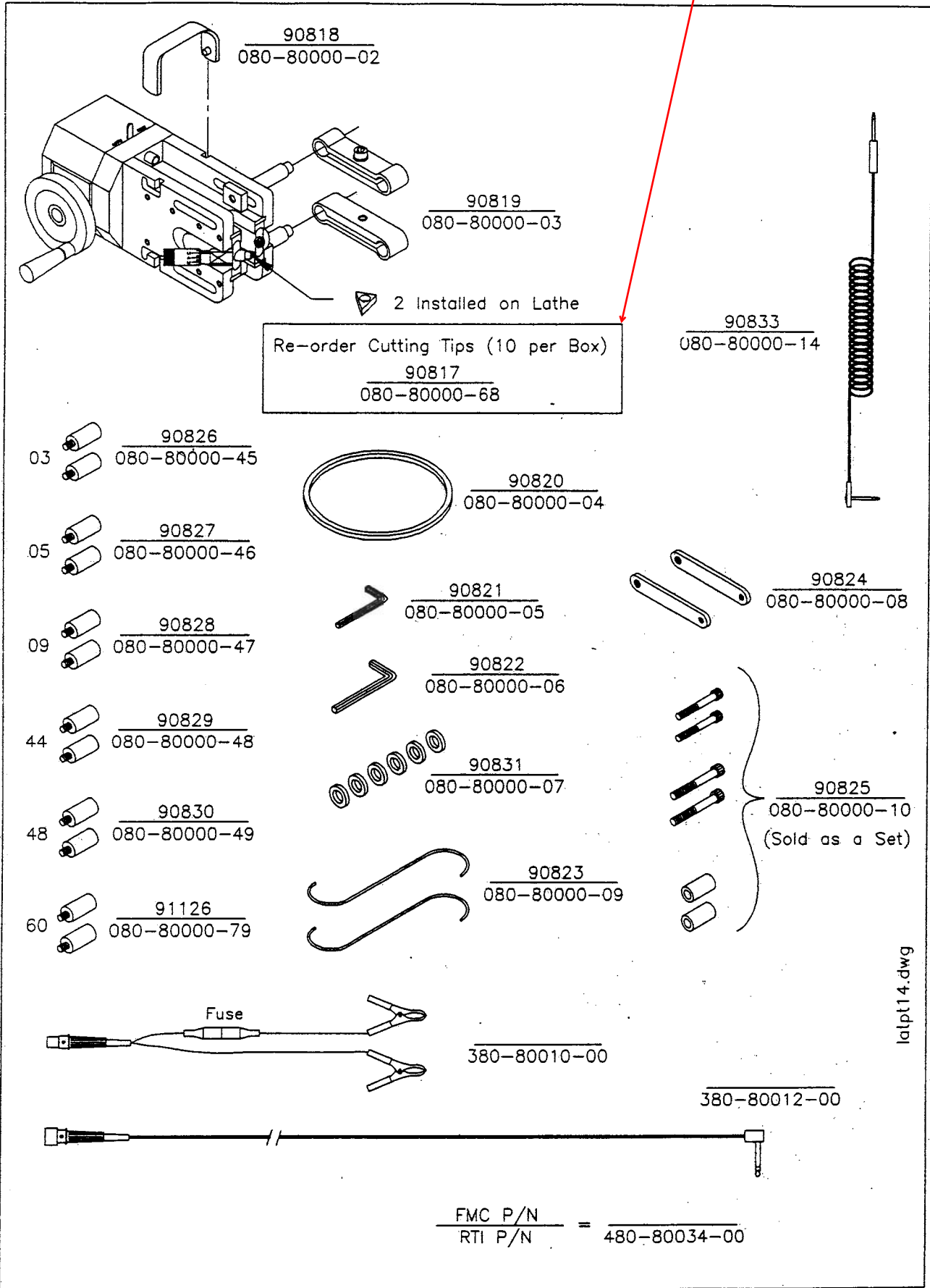

FMC & RTI Parts List – Lathe with Fixed Speed Cable Set
(All Parts Priced & Sold Individually)

pos rake tips 91212 box of 10

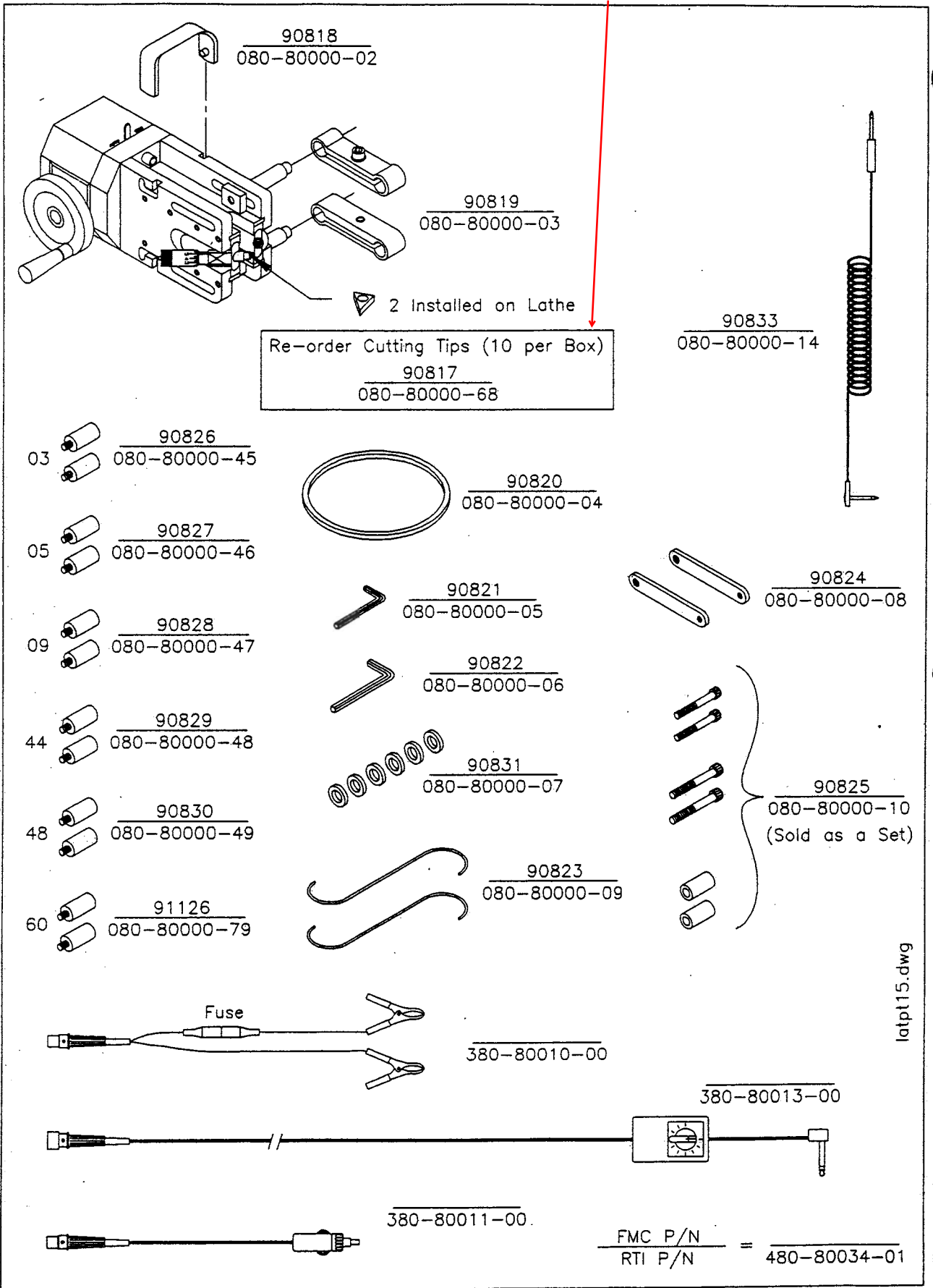

FMC & RTI Parts List - Lathe with Variable Speed Cable Set
(All Parts Priced & Sold Individually)



Cutting Tips (10 per Box)

90817
080-80000-68

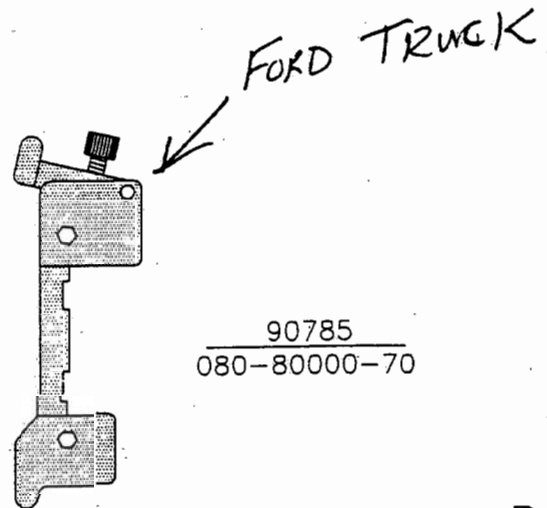
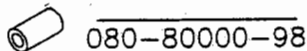
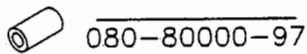
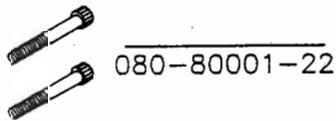
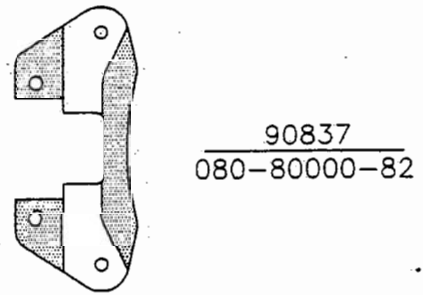
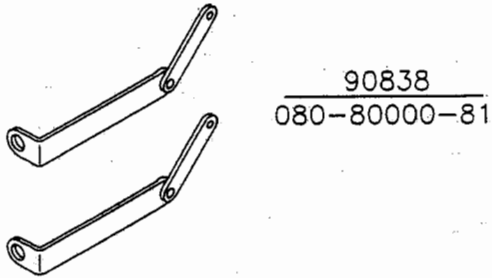
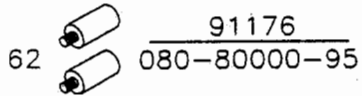
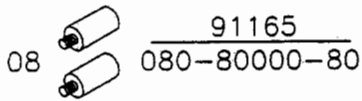
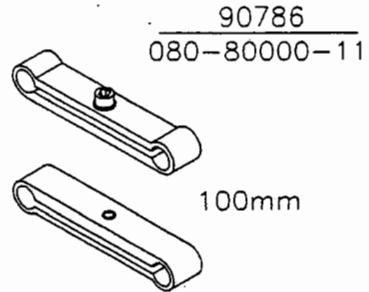

FMC P/N = 380-80009-00
RTI P/N

pt12.dwg

FMC & RTI Parts List – Deluxe Adapter Kit

(All Parts Priced & Sold Individually)

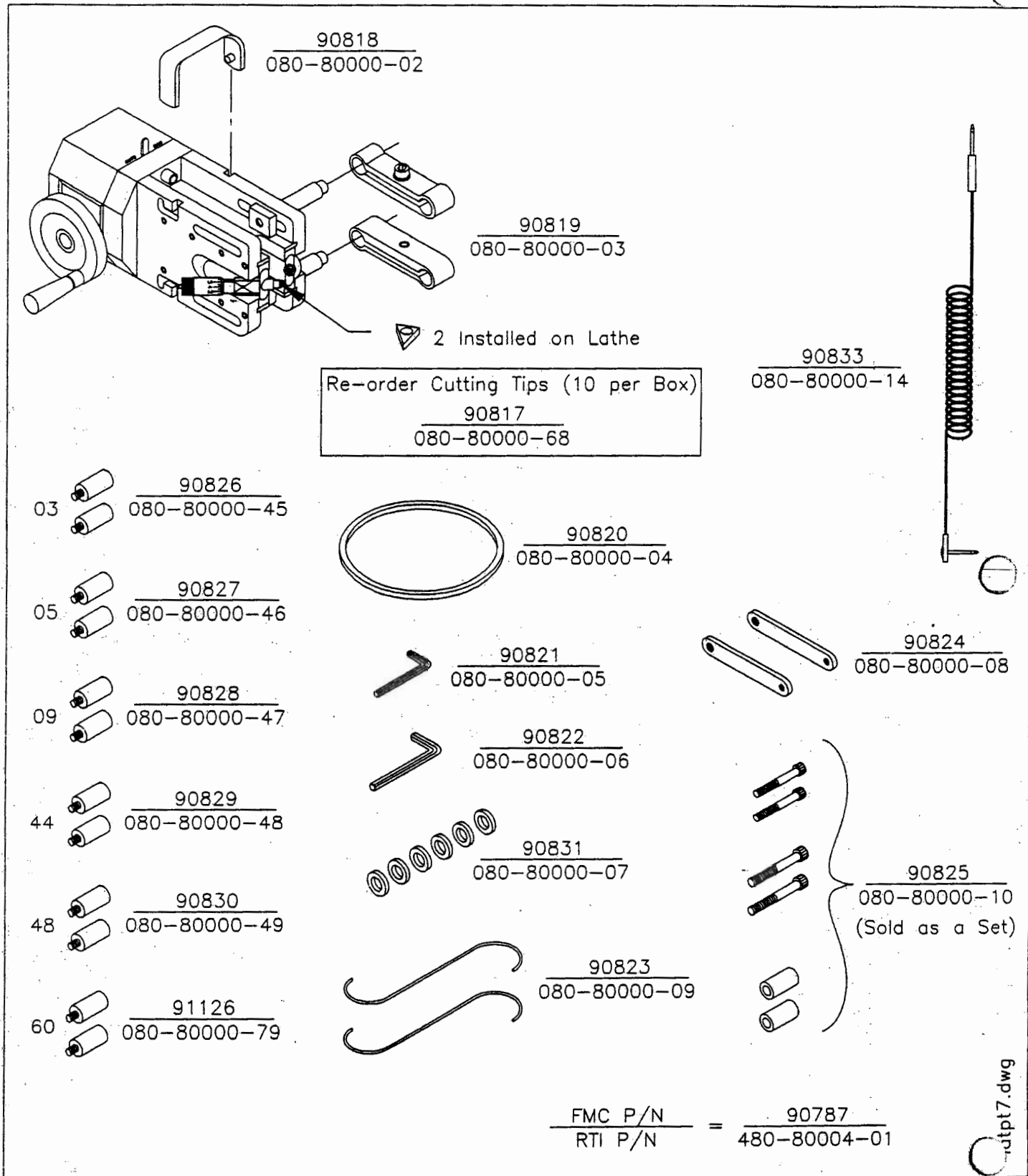



FMC & RTI Parts List - Lathe Head Components
(All Parts Priced & Sold Individually)

"FOR REFERENCE ONLY"

utpt7.dwg

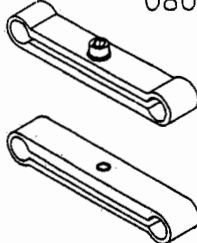
08  $\frac{91165}{080-80000-80}$

$\frac{90786}{080-80000-11}$

 100mm

 $\frac{91178}{080-80001-22}$

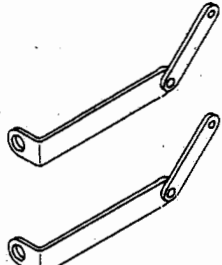
 $\frac{91177}{080-80000-97}$

$\frac{90838}{080-80000-81}$

 $\frac{\quad}{080-80000-98}$

$\frac{\text{FMC P/N}}{\text{RTI P/N}} = \frac{\quad}{380-80017-00}$

atpt13.dwg

FMC & RTI Parts List – Toyota Adapter Kit
 (All Parts Priced & Sold Individually)